



# MARTINAIRE ROUTE DESCRIPTION

# MRA 628

<b>PNS-BFM</b>	<i>ROUND TRIP (1000 LBS)</i>	PENSACOLA AVIATION 850-434-0636
<b>BFM-GPT</b>	<i>ONLY IF NEEDED – PREFER NO U/L</i>	SIGNATURE 251-433-2800

## FUEL NOTES:

ROUND TRIP FUEL SHOULD BE UPLIFTED AT PNS.

PNS- The fuel truck will meet you at night on the UPS ramp or you can leave a ticket with the fuel request in the window.

## CONTACT NUMBERS:

### CUSTOMER CONTACT NUMBERS

GPT UPS  
PNS UPS 850-432-5950  
BFM UPS

### FBO CONTACT NUMBERS

GPT MILLION AIR 228-701-0400  
PNS PENSACOLA AVIATION 850-434-0636  
BFM SIGNATURE 251-433-2800

### HOTEL CONTACT NUMBERS

GPT FAIRFIELD INN AND SUITES 15151 Turkey Creek Dr. Gulfport, MS 39503 228-822-9000  
PNS HOMEWOOD SUITES 5049 Corporate Woods Dr. Pensacola, FL 32504 850-474-3777  
Call Shuttle to pick up/drop off at UPS ramp. Room will be under Martinaire.

### WEATHER CONTACT NUMBERS

GPT ASOS 228-867-9937  
PNS ASOS 850-436-4799  
BFM ASOS 251-431-6762

## RAMP INFORMATION:

<b>LOCATION:</b>	<b>RAMP NAME:</b>	<b>FREQUENCY:</b>	<b>NOTES:</b>
<b>GPT</b>	<i>MILLION AIR</i>		Marshallers will direct.
<b>PNS</b>	<i>CARGO</i>	<i>129.42</i>	Straight off Taxiway A3, Marshallers will direct. Park facing runway.
<b>BFM</b>			

## RAMP NOTES:

PNS –Park on UPS Ramp overnight

# ***MARTINAIRE ROUTE DESCRIPTION***

***MRA 628***

---

**BFM – Park at Signature flight Support**

**GPT –Park on Million Air Ramp during the day and on the weekends.**

13234  
AIRPORT DIAGRAM

AL-576 (FAA)

GULFPORT-BILOXI INTL (GPT)  
GULFPORT, MISSISSIPPI

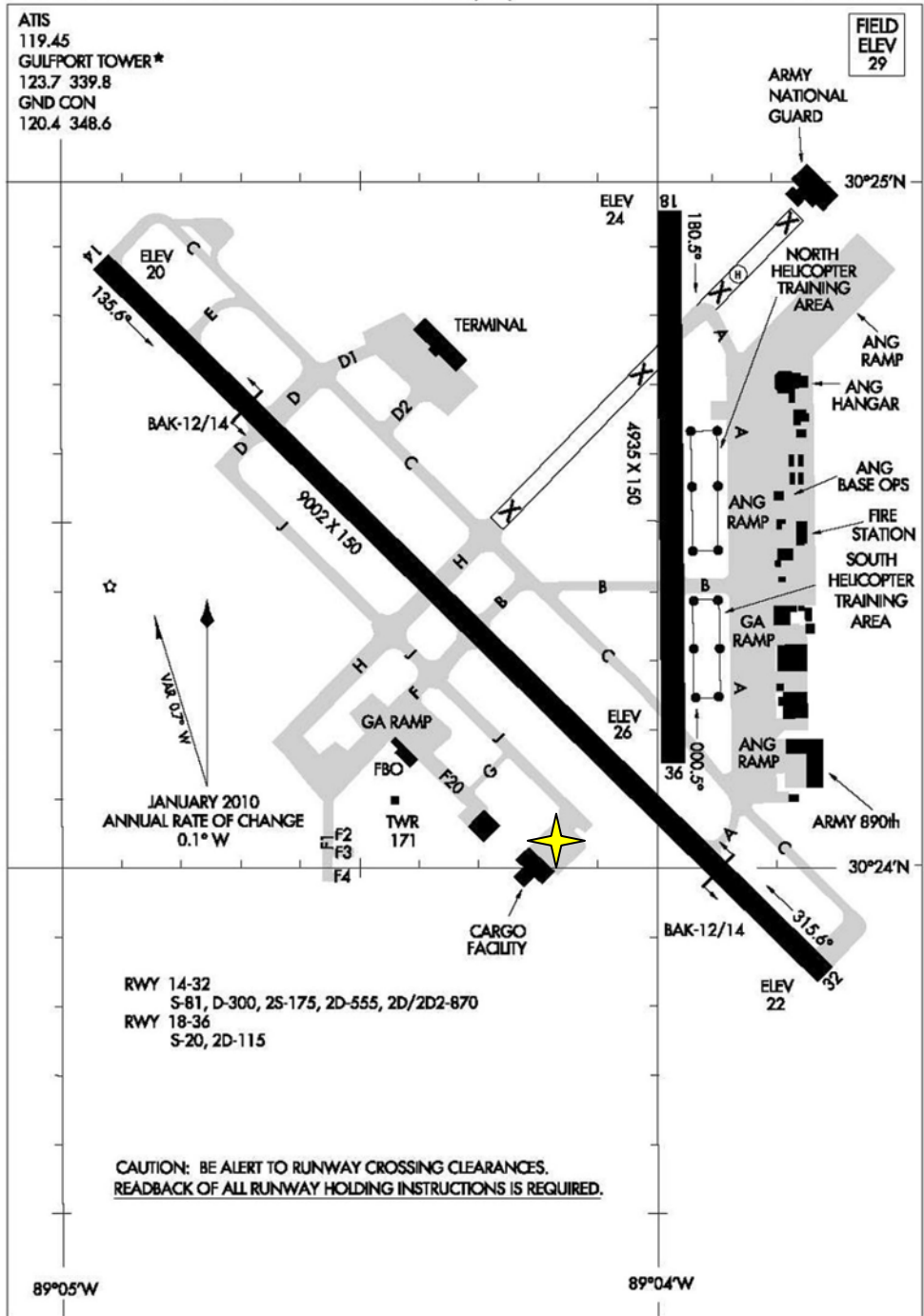

SC-4, 06 FEB 2014 to 06 MAR 2014

SC-4, 06 FEB 2014 to 06 MAR 2014

AIRPORT DIAGRAM  
13234

GULFPORT, MISSISSIPPI  
GULFPORT-BILOXI INTL (GPT)

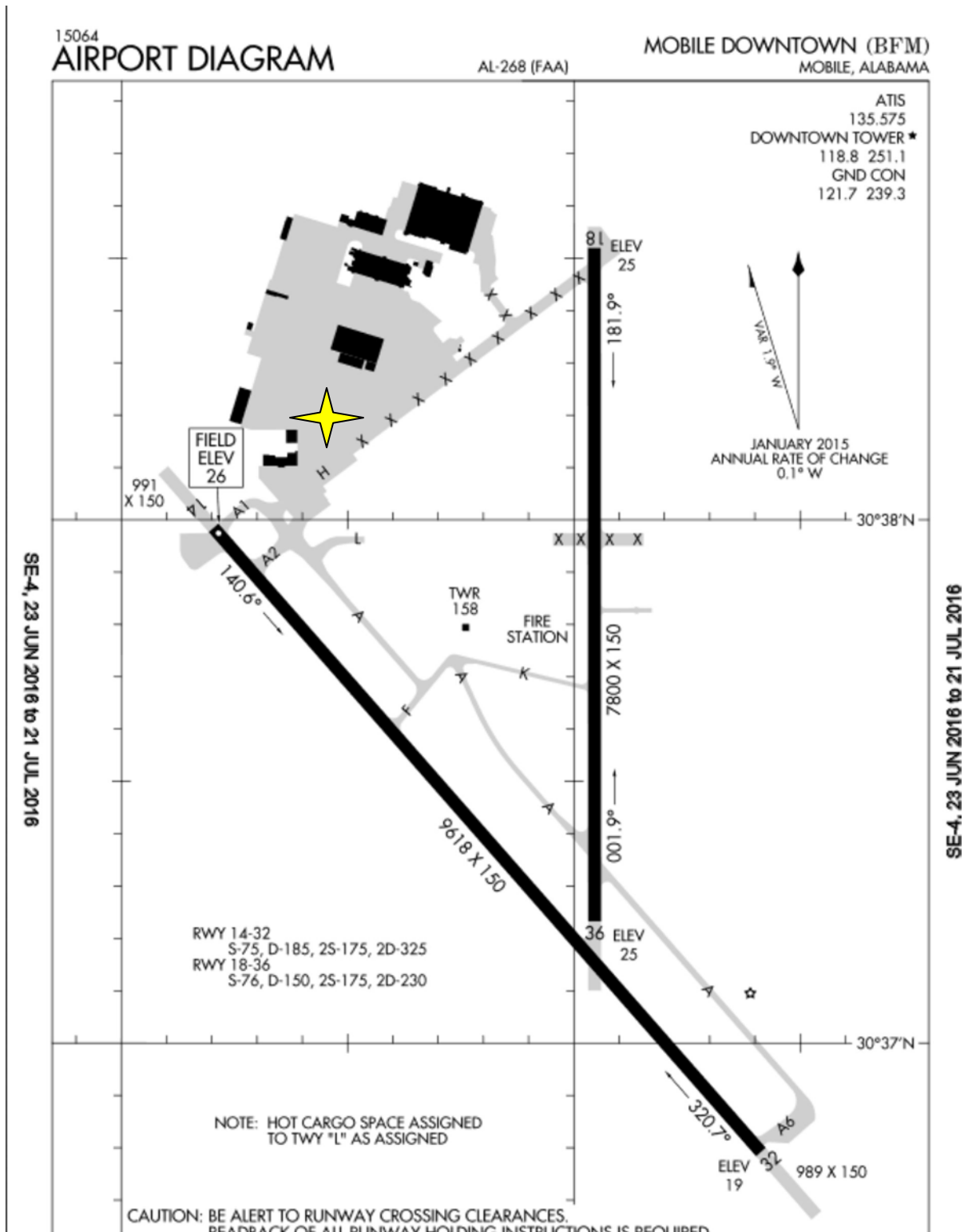

15064

## AIRPORT DIAGRAM

AL-318 (FAA)

PENSACOLA INTL (PNS)  
PENSACOLA, FLORIDA

